

FIRST FLOOR PLAN ~ 1/4"=1'-0"

AREA: 1722 SQ. FT.

2x6 STUDS @ 16" OC
AT ALL EXTERIOR WALLS
UNLESS OTHERWISE NOTED

POINT LOAD FROM ABOVE
PROVIDE THE FOLLOWING:
1) SOLID BLOCKING BETWEEN BEAM (OR BILL) AND PLYWOOD SUBFLOOR
2) A MINIMUM OF THREE STUDS IN A BEARING WALL AS BEAM JACKS

FIRST FLOOR PLATE
HEIGHT 9'-0"

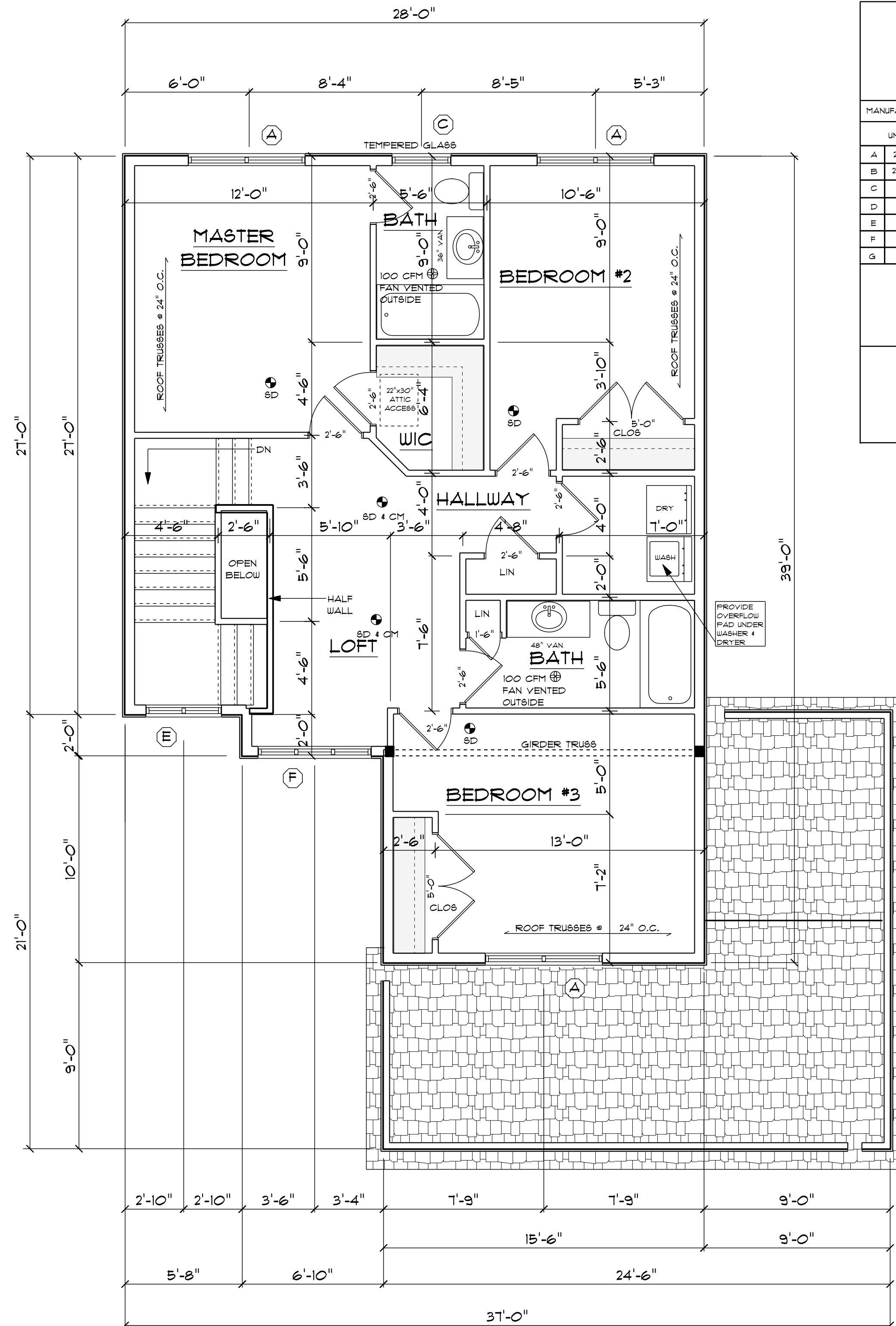

SECOND FLOOR PLAN ~ 1/4"=1'-0"

2x6 STUDS @ 16" OC
AT ALL EXTERIOR WALLS
UNLESS OTHERWISE NOTED

POINT LOAD FROM ABOVE
PROVIDE THE FOLLOWING:
1) SOLID BLOCKING BETWEEN BEAM (OR BILL) AND PLYWOOD SUBFLOOR
2) A MINIMUM OF THREE STUDS IN A BEARING WALL AS BEAM JACKS

WINDOW SCHEDULE							
TYPICAL HEADER: (2) 2" X 10"			TYPICAL HEADER HEIGHT: 6'-10"				
(EXCEPTIONS ARE NOTED ON PLANS)							
NOTE: ALL LUMBER SPECIES FOR HEADERS, JOISTS, AND BEAMS TO BE KD SPRUCE NO. 2 OR BETTER.							
ALL LOADS FOR FLOOR JOISTS, RAFTERS, HEADERS AND BEAMS ARE BASED ON THE FOLLOWING:							
FLOOR JOISTS LIVING AREAS: 40 PSF LIVE LOAD 20 PSF DEAD LOAD							
FLOOR JOISTS SLEEPING AREAS: 30 PSF LIVE LOAD 20 PSF DEAD LOAD							
MANUFACTURER (OR EQUIVALENT): HARVEY WINDOWS MIN. U-FACTOR .35							
UNIT	ROUGH OPENING	TYPE	QTY	AREA / BILL FFF	NET AREA	DESIGN PRESSURE	
A	2846-2	5'-6 1/4" X 4'-9 1/2"	DH MUL	6	24.0 / 2'-11"	5.03 EA	30
B	2846-3	6'-2 3/4" X 4'-9 1/2"	DH TRIPLE	1	36.0 / 2'-11"	5.03 EA	30
C	2832	2'-0" X 3'-5 1/2"	DH	2	9.5 / 3'-5"	3.31	30
D	2032	2'-0" X 3'-5 1/2"	DH	1	1.40 / 3'-5"	2.41	30
E	18302	3'-6 1/4" X 3'-5 1/2"	DH MUL	1	12.0 / 3'-5"	2.02 EA	30
F	18303	5'-2 1/2" X 3'-5 1/2"	DH TRIPLE	1	18.0 / 3'-5"	2.02 EA	30
G							

DOOR SCHEDULE			MINIMUM DESIGN PRESSURE FOR SLIDERS & FRENCH DOORS
TYPICAL HEADER: (2) 2" X 10"			20
(EXCEPTIONS ARE NOTED ON PLANS)			
INTERIOR AND EXTERIOR DOOR SIZES ARE NOTED ON PLANS.			
INTERIOR DOORS 6'-10" HIGH (TYPICAL)			
EXTERIOR DOORS 6'-10" HIGH (TYPICAL)			
DESIGN PRESSURE			DESIGN PRESSURE PROVIDED
WIND ZONE: 10 MPH			21.8 / -23.6
WIND EXPOSURE: C			
HEIGHT (MAX.): 35'-0"			30
PRESSURE ZONES: 4, 4, 5			

THESE DRAWINGS ARE IN ACCORDANCE WITH THE FOLLOWING DESIGN CRITERIA.

- RIBC - 2 - 2013
- WIND DESIGN: ZONE 2 (10 MPH)
- LOAD DESIGN: 40 PSF LIVING AREA LOADS
30 PSF SLEEPING AREA LOADS
20 PSF DEAD LOADS
20 PSF ATTIC LOADS
60 PSF EXTERIOR DECK LOADS
30 PSF SNOW LOADS
- FROST DEPTH: MINIMUM 3'-6" DEEP
- CLIMATE ZONE: 5A
- CONSTRUCTION TYPE: 5B
- OCCUPANCY TYPE: R3
- BUILDING HEIGHT: (MAXIMUM 35'-0")
MEASURED FROM TOP OF FOUNDATION TO RIDGE
- ALL INSULATION IN EXTERIOR WALLS ARE BASED ON THE MINIMUMS AS PER THE PRESCRIPTIVE METHOD OF TABLE N102.1.2 OF THE ENERGY CONSERVATION CODES.

CUSTOM SHOTGUN COLONIAL
PREPARED FOR:
COLLICH ORGANIZATION
AP 61, LOT 264, SPRING VALLEY DRIVE
EAST GREENWICH, RI

DLR DIMENSIONS, INC.
RESIDENTIAL DESIGNERS
612 GREENWICH AVENUE
WARWICK, RHODE ISLAND 02886
PHONE (401) 398-3156
EMAIL: DLRDIMENSIONS@gmail.com

DLR DIMENSIONS, INC.
IS NOT RESPONSIBLE FOR
CHANGES TO NOTES,
DIMENSIONS, FINISHES,
AND/OR CONTRACTOR
BUILDER/CONTRACTOR
MUST VERIFY
ALL DIMENSIONS AND
FINISHES WITH
LOCAL CODES
PRIOR TO AND
DURING CONSTRUCTION.

SCALE
NOTED

DATE
Monday, January 14, 2019

APPROVED
DRR

DRAWN BY
DRR

DRAWING NUMBER
5491